

EN

## HEALTH, STYLE AND DURABILITY, PERFECTLY BALANCED

Enjoy hot or cold beverages in their crispest form—fresh from this pure borosilicate glass bottle. Free yourself to switch between beverages without the worry of the bottle absorbing smells or flavors. The glass thread-free mouthpiece is smooth to drink from. Rapid Lock™ Technology, a 1/4-turn locking cap system is secure, locks with a click, is leak-proof, and worry free. BPA and phthalate free.

# ZOKU®

## GLASS CORE BOTTLE

### WITH TEA INFUSER

#### CARE & USAGE

#### CARE & USAGE:

- BOTTLE AND PARTS ARE NOT DISHWASHER SAFE
- Wash bottle and cap by hand thoroughly with soap and warm water before first use
- Clean outer bottle with soft bottle brush
- Store with cap off to allow components to dry completely in between uses
- Do not submerge assembled bottle in water
- If condensation forms between layers of the bottle disassemble all of the parts and let thoroughly dry

- Dry thoroughly before reassembling
- If necessary clean glass with a gentle cloth to prevent scratches; do not use a scrub brush
- It is not necessary to disassemble the bottle often to clean it

#### ⚠ WARNING:

- THIS PRODUCT CONTAINS GLASS
- GLASS BOTTLES WILL BREAK; HANDLE WITH CARE AND DISCARD IMMEDIATELY IF BROKEN
- THERE IS A RISK OF SKIN/HAND/FACE LACERATIONS DUE TO BREAKAGE OF THE GLASS BOTTLE
- Always inspect glass before use for sharp edges and fragments or flakes of glass that may have become dislodged and are loose inside the bottle
- Do not use if there are any signs of chips or cracks
- If water leaks from bottle the glass is broken. Do not continue to use or could result in injury
- Glass core of bottle may break, but the glass mouthpiece may remain intact. If glass is broken anywhere, discard and do not continue to use
- This glass product is not for children; do not leave the bottle unattended with children
- The silicone cushions and encapsulated shell protect the glass, but do not guarantee against breakage
- Extreme temperature differences between liquid and glass core may cause glass to break

#### ⚠ CAUTION:

- THIS BOTTLE IS DESIGNED TO HOLD LIQUIDS THAT MAY BE HOT ENOUGH TO SERIOUSLY BURN YOU, USE CAUTION WHILE DRINKING HOT BEVERAGES
- IF FILLING WITH HOT LIQUID, ALLOW LIQUID TO COOL DOWN WITH THE LID OFF FOR AT LEAST 3 MINUTES BEFORE ATTACHING THE LID. IF NOT, RISK OF BURNING
- Do not use with boiling hot liquids
- Hot liquids can leak if bottle tips on its side; prevent from putting in a bag with hot liquids in the bottle
- Not intended for use with carbonated beverages

- Do not overfill. Fill only to the point where the glass extends beyond the plastic and silicone collar
- Do not over tighten the top cap. Cap is secure once the threads engage; audible “click” sound
- Do not microwave or freeze the bottle

#### QUESTIONS?

For questions regarding this or any other Zoku product, visit [www.zokuhome.com](http://www.zokuhome.com)

©2019 by ZOKU  
ZOKU, LLC Hoboken, NJ 07030

#### DISASSEMBLE TEA INFUSER

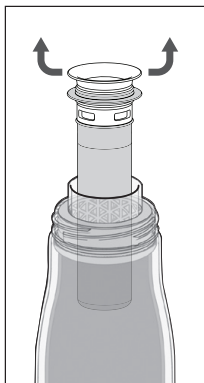

- 1 Lift the infuser by the mouthpiece to remove from bottle

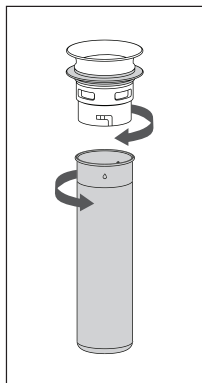

- 2 Unscrew the mouthpiece and separate it from the tea basket

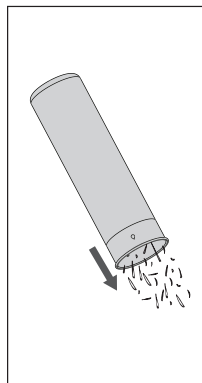

- 3 Dispose used tea leaves from basket and rinse thoroughly

#### DISASSEMBLE CAP

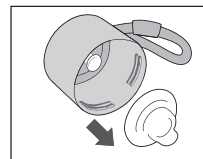

- 1 Remove silicone piece by pulling on tab

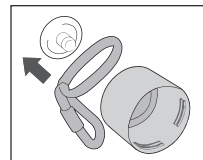

- 2 Push top plastic piece out from inside of cap to remove rope

#### DISASSEMBLE BOTTLE

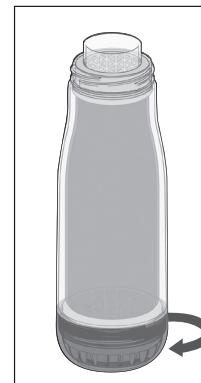

- 1 Remove outer shell by unscrewing lid and bottom cap

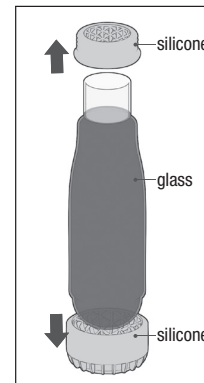

- 2 Remove silicone pieces and clean glass gently with soft cloth